

THE DRAWINGS AND INFORMATION CONTAINED HEREIN ARE THE EXCLUSIVE PROPERTY OF ACTEL. THE INFORMATION CONTAINED HEREIN IS UNCLASSIFIED AND DESIGN CONCEPTS CONTAINED HEREIN ARE CONFIDENTIAL/PROPRIETARY AND SHALL BE MAINTAINED IN STRICT CONFIDENCE. AND SHALL NOT BE RELEASED TO ANY THIRD PARTY WITHOUT THE EXPRESS WRITTEN PERMISSION OF ACTEL.

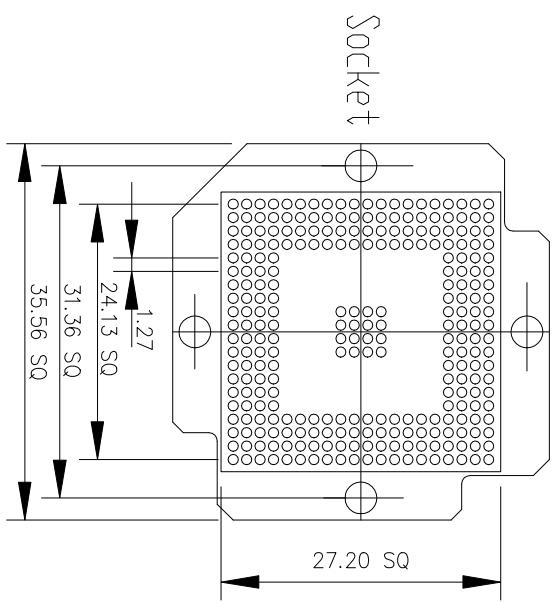
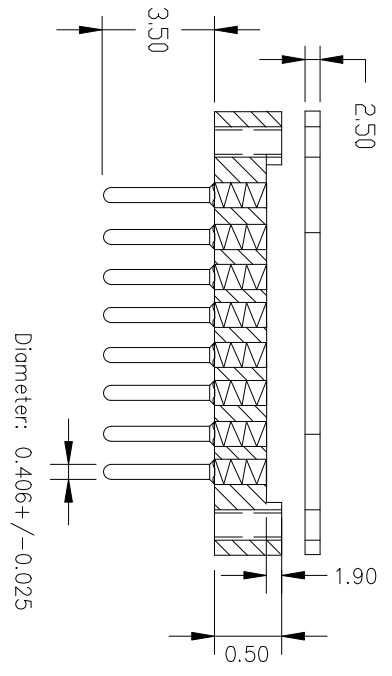

REV.	DESCRIPTION OF CHANGE	EFFECTIVE DATE	ORIGINATOR
0	Initial	5/6/99	Ray Kuang
1	change E-tec number to BPW272-1270-20AC11	1/6/2000	Ray Kuang

E-TEC PART#: BPW272-1270-20AC11  
E-TEC PATENTS PENDING

- NOTES: Dim: mm
- PIN MATERIAL: BRASS ALLOY 360, 1/2 HARD.
  - PIN FINISH: 10 μ" GOLD OVER 50 μ" NICKEL.
  - INSULATOR MATERIAL: FR-4 GLASS EPOXY
  - Contact: BeCu with gold plated

ACTEL CONFIDENTIAL

UNLESS OTHERWISE SPECIFIED DIMENSIONS ARE IN MILLIMETERS		PRODUCTION	
DECIMAL	X X ±0.10	APPROVALS	
ANGULAR	±1°	DRAWN	DATE
		Ray Kuang	4/27/99
		CHECKED	
		INCR	
		RELEASED	
TITLE		ACTEL CORP	
272-27 x 27mm, 1.27mm E-TEC BGA SOCKET		955 B ARQUES AVE	
TITLE		SUNNYVALE CA 94086	
Vendor Name: E-TEC		ACTEL DWG. NUMBER: 1-07-09038	
Vendor ID(PART) NUMBER: BPW272-1270-20AC11		Vendor Dwg. Number	
Acad Part# SE-96272-4		SCALE: NONE	
		SHEET 1 OF 2	